



**FEEL THE TOUCH OF EXCELLENCE WITH SUPERIOR
CLEAN ROOM DESIGN WITH EXECUTION WORK.**

**We Provide Extra Ordinary Services in
Cleanroom Segaments Trunkey Project.**

- Cleanroom Panel(CRP)
- Cleanroom Door(CRD)
- Cleanroom Ceilling(CRC)
- View Panel
- Epoxy Flooring
- Steel Furniture

And advanced & extra ordinary
Cleanroom Product range

+91-8469131313
saisevaservice@gmail.com
info@saisevaservice.in
101,Raj Orion Complex,
Nr.Palanpur Canal Road,Adajan,Surat.

Branch Office :
BHAVNAGAR , AHMEDABAD , VADODARA
www.saisevaservice.in

Clean Rooms

Clean room pre engineered modular system offers a cost effective alternative to the conventional construction at the same time it delivers durable and high quality clean room performance.

Partition Panel

At Sai Seva Service, we design and manufacture clean room facilities that perfectly suit with our customer's tastes and preferences. We offer a complete range of cleanroom partition & ceiling system. These systems fulfill the technical requirements of high specification, controlled environment such as pharmaceutical, biotech and microelectronics, as well as food processing plants. Our advanced production technologies make sure that we meet our customer's environmental needs, which are flexible and the date can be extended in case of a requirement.

Wall Types

- . Pre-Painted Galvanised Iron (PPGI)
- . Powder-Coated Galvanised Iron (PCGI)
- . High Pressure Laminate Wall (HPL)
- . Glass Panel Wall
- . Stainless-Steel Wall
- AND Many More [As Per Customer]

Features

- . Removable & Re-locatable
- . Cost-Effective & Alternative to Conventional Construction
- . Built to drawing layout, minimal alteration required
- . Fast and easy installation
- . Pre-fabricated cut out for utilities
- . Totally flush concept.
- . Highly corrosive resistance, durable

Specification

- . Panel thickness : 50mm/80mm/100mm/150mm
- . Standard wall partition are a composite construction of two skins pre-coated GI.
- . Powder-Coated Aluminium/SS/Aluminium composite
- . Insulation put (40 kg / M³), rock wool, PRI-PUFF
- . Fire Resistance Material

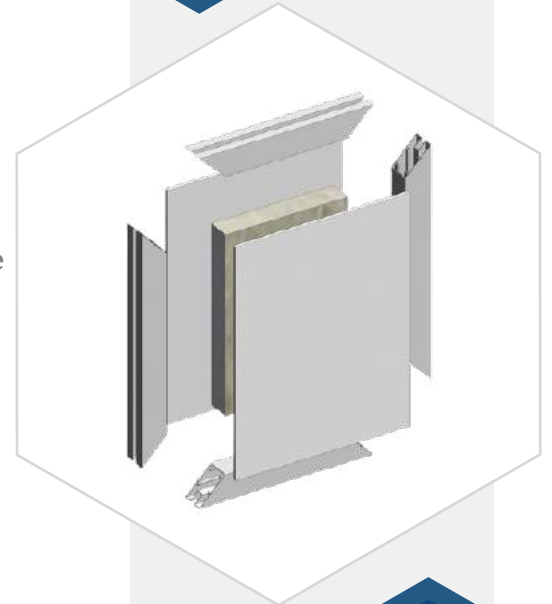
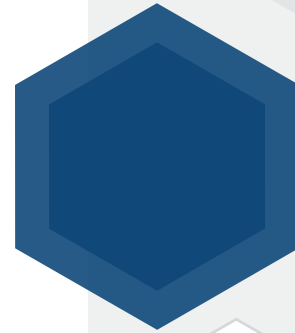

Clean Rooms Doors / GI Metal Doors

Doors

Features

- . Fully Flush surface with wall system
- . A large variety of swing out doors
- . Manual / Semi-automatic & Fully Automatic sliding doors
- . Best in class door hardware
- . Custom dimensions available
- . Heavy-Duty structure for high durability



Door Accessories

Kick Plate

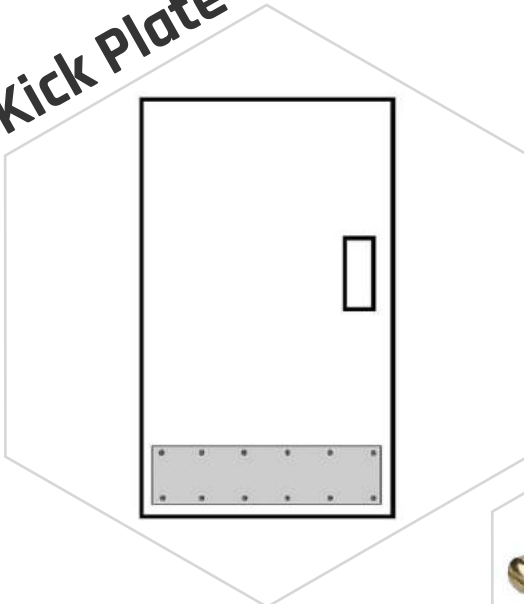

Drop Seal



Handle



Door Closer



Lock Cylinder



Clean Rooms Ceiling

Ceiling

Specification

- . Standard Size: 1200 X 3000 mm(Up to 6000 Length)
- . Moc: GI Powder-Coated / GI Pre-Coated / SS-304 / PVC Laminate
- . Skin Type: gsp / SS 304 Sheets
- . Panel thickness: 50/80/100 mm
- . Factory-made cut outs(for filter , light fixtures & Other Service)
- . Types : Walkable / Non-walkable
- . In Fill : Puff(40kg/M3)
Rockwool(96kg/M3)
Other In Fill Option(As per customer Requirement)
- . Ceiling Suspension



Pass Box



Dynamic Passbox

Non-Classified To Classified Area

SS 304 Material

Different Sizes(As Per Customer Required)

Static Passbox

Classified to Classified Area

SS 304 Material

Different Sizes(As Per Customer Required)

Modular OT [Operation Theater]

Modular OT pre engineered modular system offers a cost effective alternative to the conventional construction at the same time it delivers durable and high quality Operation-Theater performance.

Operation Theater

Features

- . Design As Per NABH Norms
- . Class 100 to 10,000
- . HVAC Design 20,10,3 & 0.3 micron Filtration
- . SS / Aluminum LAF Hepa Bad
- . Surgeon Control ELE Panel
- . Cleanroom Puff Partition Panel
- . Epoxy / Vinyl / PU Flooring
- . Glass View Panel
- . Pass Box

OT Advantages

- . Seamless & Easy Clean
- . Chemical Resistant
- . Durable Life Expectancy in excess 10 years
- . Cost Effectiveness Last 3 to 4 times longer than fungicidal paints.
- . Long Term Savings need not be replaced at the End of design lives.

Types Of Modular OT

- . Modular OT
- . IVF Lab
- . Orthopedic OT
- . Cath Lab
- . Ophthalmic OT
- . AND All types of Modular OT

All Types OT Creates are according to NABH Norms.



Your ultimate guide in clean room design
& project execution

Accessories

Return Air Grill

Features

- . Made From GI & Stainless Steel(As per Customer required)
- . Custom size(As per Standard)
- . Easy Maintenance & Cleaning
- . Perfectly flush-fitting with the wall

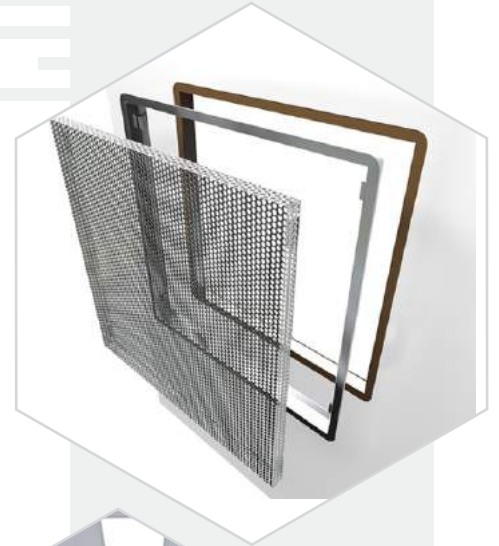

Glass View Panel

Features

- . Heat Resistant
- . Surface treatment coated
- . 5mm thick & Many More
- . Custom size(As per standard)



Clean Room Lights

Features

- .Types : FLP [Flame Proof]
Non-FLP [Non Flame Proof]
- .Custom Size(As per required)
- .Perfectly Flush Fitting With the ceiling



Corner Coving

Features

- . Coving Material Aluminum Powder Coated
- . Colour As per Customer Need

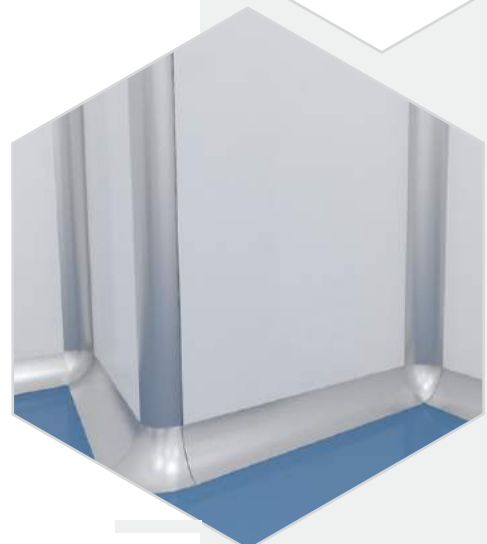

Clean Room Flooring & Furniture

Epoxy / PU / Vinyl

Features

- . Appearance :Glossy / Matt
- . Thickness [As Per Customer Required]
- . PU Surface Finish
(No Wax / No Polish)
- . Anti-Bacterial
- . Antistatic
- . Solvent -free
- . Resistant to most chemical agents diluted with acids, bases, oils and fuels
- . Smooth matte effect

Furniture

Fumes Hood

- Types :
- . Bench Mounted Types
 - . Low Bench Type for distillation
 - . Walk in Hood
 - . Unit with Auxiliary chamberz

Laminar Air Flow Unit[LAF]

- . U.V Light with Hour Meter
- . Night Mode Operation
- . Hygiene brand pre filter
- . EU6-Prefilter[95% down to 5 micron]
- . SS 304 work table with due reinforcement
- . DOP Test Port
- . Tough glass side panels

Laboratory Furniture

- . Wall mounted / sliding door unit
- . Anti-vibration table
(Black Granite , Epoxy , Laminate)
- . Mobile Drawer Unit
- . Walk In Hood
- . Sink Units(SS 304,PP,FRP)
- . Wall & Central work table

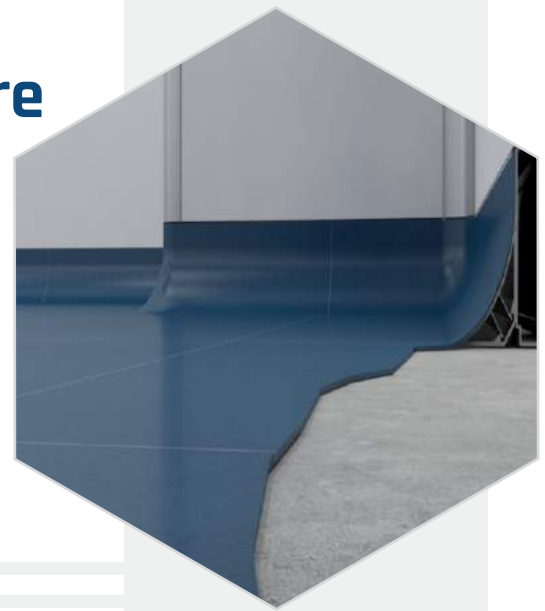

OUR CLIENTS

[Pharmaceutical] [Customer]

- . K Patel Phytoextraction Group
- . Chiron Behring Vaccines pvt. ltd.
- . Cipla ltd.
- . Trio healthcare pvt. ltd.
- . Arkray Healthcare pvt. ltd.
- . Anupam Rasayan ltd.
- . CTX Lifescience pvt. ltd.
- . Aushadhi wellness pvt. ltd.
- . Pharmawind healthcare pvt. ltd.
- . Globela Pharma pvt. ltd.
- . Chemox pharma pvt. ltd.
- . Kenoor Organics pvt. ltd.
- . Basic pharma lifescience pvt. ltd.
- . Basic international
- . ORBIT Pharmaceuticals
- . Chiral Drug pvt. ltd.
- . Galaxy Surfactants
- . Perfect Medicare pharma
- . Sahajanand medical pvt. ltd.
- . R N Laboratries pvt. ltd.
- . Maruti Healthcare
- . Ajanta Pharma pvt. ltd.
- . Kumar Organic
- . Guj Indo lifecare pvt. ltd.
- . Rajasthan Herbal international pvt. ltd.
- . Viswaat Chemical ltd.
- . Unitop Chemical pvt. ltd.



OUR CLIENTS

- . Voltbek Home Appliances pvt. ltd.
- . Reliance industries limited
- . GHCL ltd.
- . UPL ltd.
- . Aether Industries ltd.
- . Madhu Silica pvt. ltd.
- . Shell Mach Industries ltd.
- . Investment Casting pvt. ltd.
- . Nirma ltd.
- . Hil ltd. Golan[CK BIRLA GROUP]
- . Orgo Chem Industry
- . Bhavnagar Electricity Corporation ltd.
- . ATC Tires pvt. ltd.
- . Gujarat Industry Power Co. ltd. [GIPCL]
- . Surat Lignite Power Plant



[Industry Customer]



[Hospital Customer]

- . Wings Hospital [Surat,Udaipur]
- . Apollo Group
- . Janak Smarak Hospital [Vyara]
- . Eye Hospital [Surat]
- . Porbandar Critical Care LLP [Porbandar]
- . Embrion Hospital [Surat]
- . SRL Dignostics [Surat]
- . Prime Hospital [Rajkot]
- . Mehta Hospital [UNA]
- . Abhishek Hospital [Vadodara]
- . Shree Orthopaedic Hospital [Godhra]
- . Bharuch Orthopedic Hoapital [Bharuch]
- . Maanit Neuro Care [Rajkot]
- . Fortune Medical [Bharuch]

Detailing Drawing

Cleanroom Ceiling

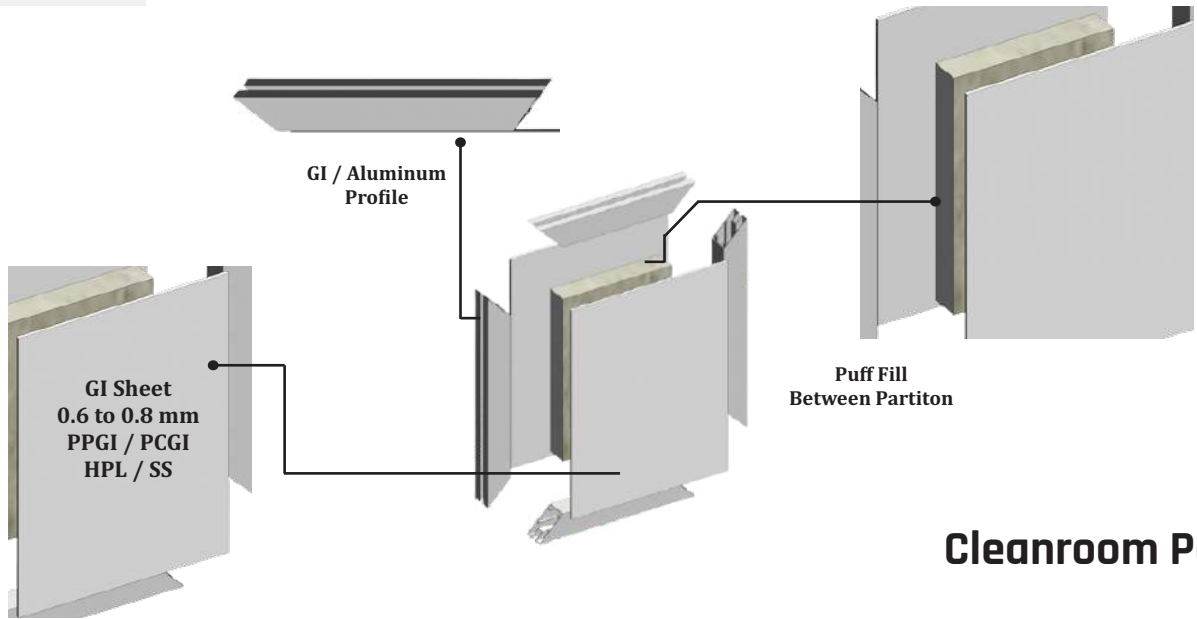
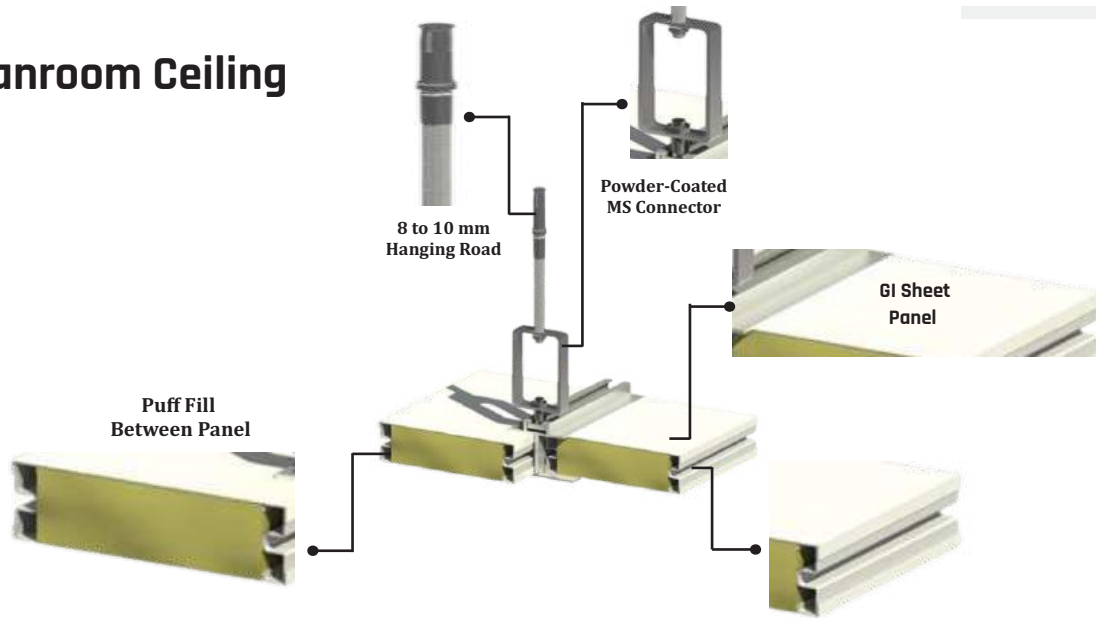

Cleanroom Partition

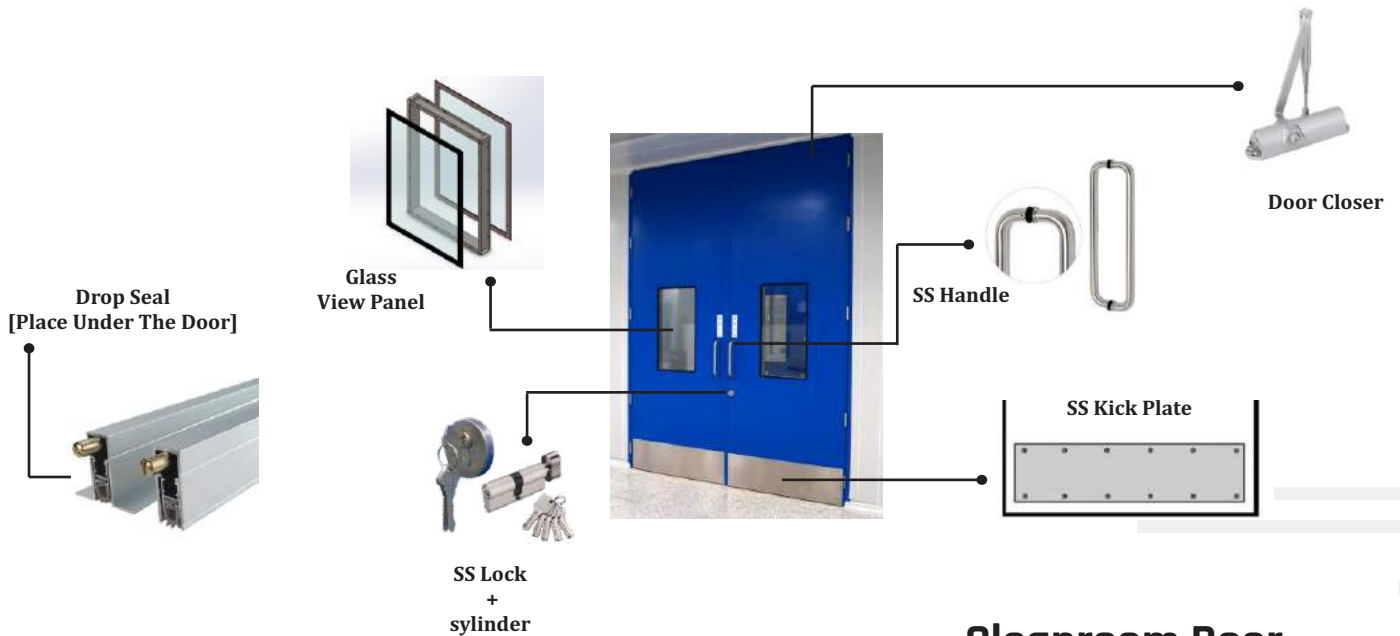

Cleanroom Door



M : +91-8469131313

**E : saisevaservice@gmail.com
info@saisevaservice.in**

**A : 101,Raj Orion Complex,
Nr.Palanpur Canal Road,Adajan,Surat.**

Branch Office :

BHAVNAGAR , AHemdABAD , VADODARA

www.saisevaservice.in